



## Caterware CW-GB4-30HP 4 Open Cooktop Gas Burners, 30cm Hotplate on Stand

Project #: \_\_\_\_\_ Item #: \_\_\_\_\_



CW-GB4-30HP

### Standard Features:

- \* AISI 304 Grade Stainless Steel
- \* Heavy duty stainless stand plus undershelf included as standard
- \* 4 Open Burners and 30cm Hotplate
- \* Heavy duty stainless construction
- \* Flame failure protection and pilots
- \* Gas control valve for easy setting of flame
- \* Heavy duty cast iron trivets and burners
- \* Heavy duty mild steel grill plate (20mm thick)
- \* High output cooktop burners x 4 (30Mj Natural Gas, 27Mj LPG)
- \* 1 x 21Mj Tube Burner for Hotplate
- \* Easily serviceable components
- \* Removable drip trays for easy cleaning

### Options: LPG or Natural Gas

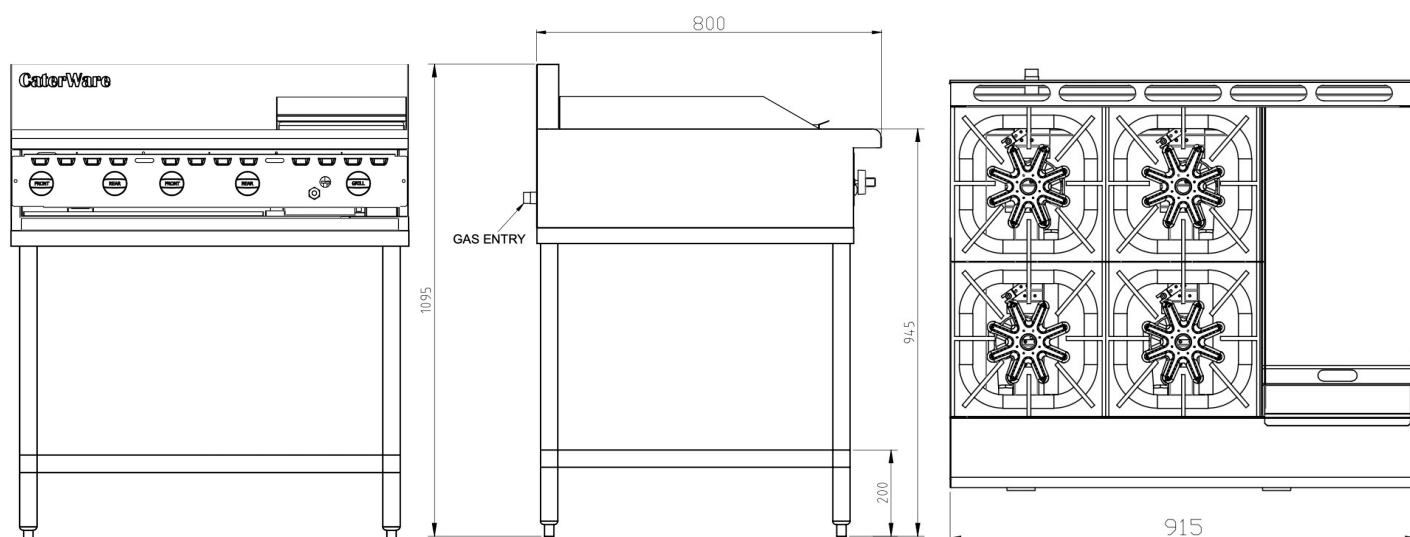

Width (mm)	Depth (mm)	Height (mm)	Net Weight (kg)	Gas Consumption (Mj/h)	
				Natural Gas	LPG
915	800	1095	102	141	129

Unit <b>Must</b> be installed by an authorised technician in accordance with <b>AS5601</b> Gas regulator included with each unit Caterware reserves the right to alter specifications				Supply Pressure (kPa)	
				Gas (BSP)	
				3/4" Male	
				Natural Gas	LPG
				1.0	2.65



**Approval Number**  
**GMK 10393**

**CaterWare**  
2/6 Resources Crt, Molendinar, QLD. 4214 Australia  
caterware@icloud.com      www.caterware.com.au

Phone: +61 7 5597 5599