



CaterWare CW-GB04 4 Open Cooktop Gas Burners with Oven

Project #: _____ Item #: _____



CW-GB04

Standard Features:

- * AISI 304 Grade Stainless Steel
- * Oven with 4 Open Burners
- * Heavy duty stainless construction
- * Flame failure protection and pilots
- * Gas control valve for easy setting of flame
- * Heavy duty cast iron trivets and burners
- * High output cooktop burners (30Mj Natural Gas, 27Mj LPG, 25mJ Oven)
- * Easily serviceable components
- * Removable drip tray for easy cleaning

Options: LPG or Natural Gas

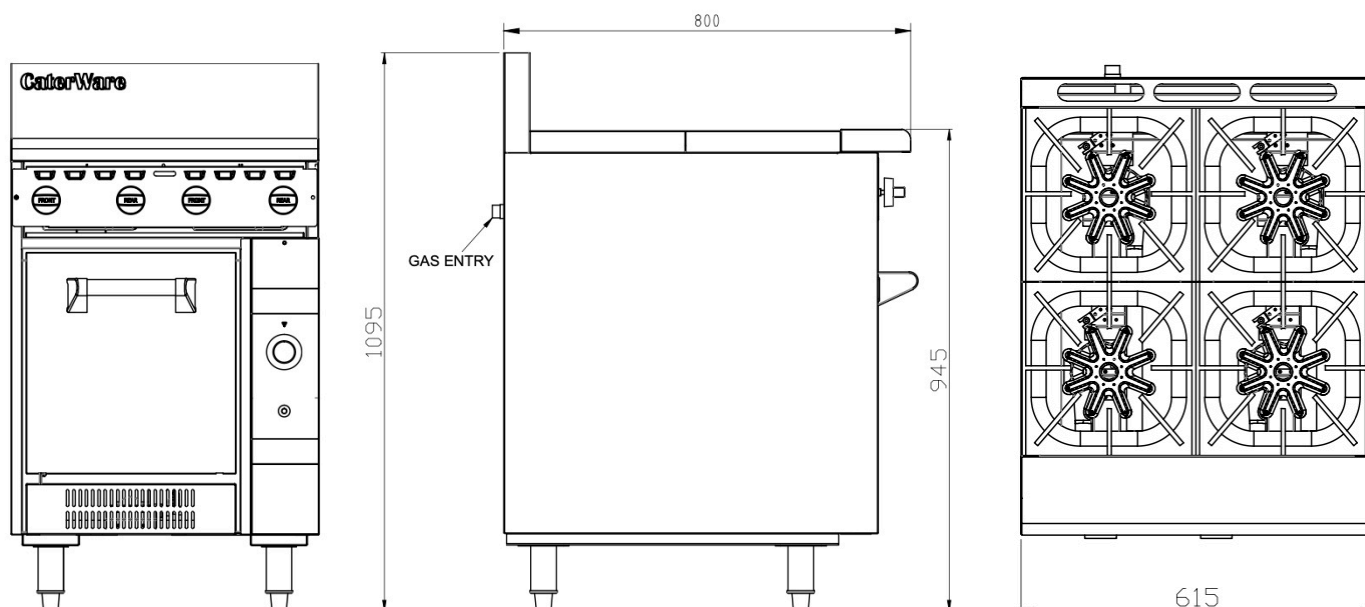

Width (mm)	Depth (mm)	Height (mm)	Net Weight (kg)	Gas Consumption (Mj/h)	
				Natural Gas	LPG
615	800	1095	172	145	133

Unit Must be installed by an authorised technician in accordance with AS5601 Gas regulator included with each unit Caterware reserves the right to alter specifications				Supply Pressure (kPa)	
				Gas (BSP)	
				3/4" Male	
				Natural Gas	LPG
				1.0	2.65



Approval Number
GMK 10393

CaterWare
2/6 Resources Crt, Molendinar, QLD. 4214 Australia
caterware@icloud.com www.caterware.com.au

Phone: +61 7 5597 5599